

DATASHEET

XS4 LOCKER by SALTO

The XS4 Locker Lock BLE provides high level security to a wide range of lockers, cupboards, cabinets, boxes, etc. by integrating it into the SALTO wirefree electronic access solution. Its new electronics permits to integrate Bluetooth technology allowing the usage of JustIN Mobile technology and SALTO BLUEnet wireless online technology through the same hardware. It is now possible to customize the level of functionality you need just by programming the device as desired.

The battery pack, electronic components and locking mechanism are all located on the inside of the door, safe from potential vandalism or sabotage.

www.saltosystems.com

XS4 LOCKER Lx050

SALTO
inspired access



TECHNICAL DATA:

| | |
|----------------------------------|---|
| Outside escutcheon measurements: | 54mm x 105mm x 28mm |
| Inside cover measures: | 100mm x 110,5mm x 25mm |
| Door thickness: | 10mm up to 50mm adaptable on site. |
| Deadbolt projection | 15mm |
| Power source: | 3 alkaline batteries (LR03 AAA 1,5V). Optional 3 Lithium batteries (FR03 - AAA 1,5V). |
| Number of openings: | <ul style="list-style-type: none"> • Mifare: 75.000* • BLE: 60.000* |
| Maximum events on lock audit | 1,861 |
| Environmental conditions: | Temperature: 0°C to +60°C; Humidity: 0 to 95% |
| Certifications: | CE, FCC, IC, RCM |
| Material: | <ul style="list-style-type: none"> • Anthracite finish (A) • PC+ABS + BioCote • White Finish (M) • ASA-PC + BioCote |

* Depending on the usage

ID TECHNOLOGIES:

| | |
|-----------------------|---|
| BLE MIFARE*: | • |
| BLE Smart: | • |
| NFC: | • |
| Legic**: | • |
| BLE HID iClass® Seos: | • |
| Picopass: | — |

* MIFARE® (DESFire EV2, Plus, Ultralight C, Classic - ISO/IEC 14443).

** Legic Prime and Legic Advant

TECHNOLOGY PLATFORMS:**SALTO SPACE:**

| | |
|--------------------------|---|
| Smile - Selfprogrammable | — |
| ROM: | — |
| SVN data-on-card: | • |
| SALTO RFnet: | — |
| SALTO BLUEnet*: | • |

* BLUEnet communication on metal door may need to install more BLUEnet nodes or repeaters.

SALTO KS:

| | |
|------------|---|
| SALTO KS*: | • |
|------------|---|

* Locker functionalities in development

SALTO SALLIS:

| | |
|---------|---|
| SALLIS: | — |
|---------|---|

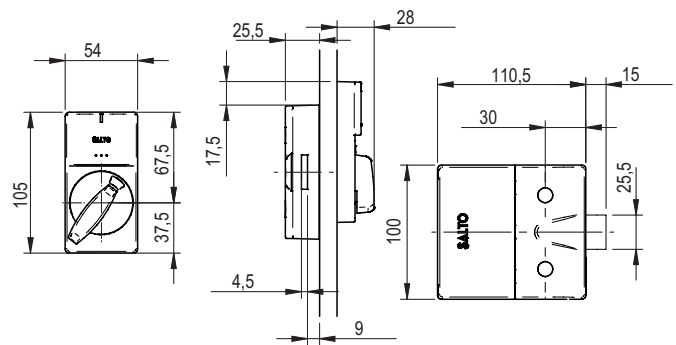
TECHNICAL DRAWING:**OPTIONS:****Reader colour:**

| | |
|-------------|---|
| Anthracite: | • |
| White*: | • |

*White outside, anthracite inside

Special features:

Comes with BioCote® Silver Ion antimicrobial technology

OPENING MODES:

| | |
|--------------------------|---|
| Fixed locker assignment: | A specific user ID carrier operates a specific locker lock. |
| Free locker assignment*: | Any user ID carrier subsequently used to unlock a locker takes control. |
| Family option: | Multiple user ID carriers to operate a single locker. |

* Compatible with RFID and NFC.

Not available for smartphone using BLE.